

CYLINDER HEAD (I) ASSEMBLY

B3E011010100E04

1. Assemble in the order indicated in the table.

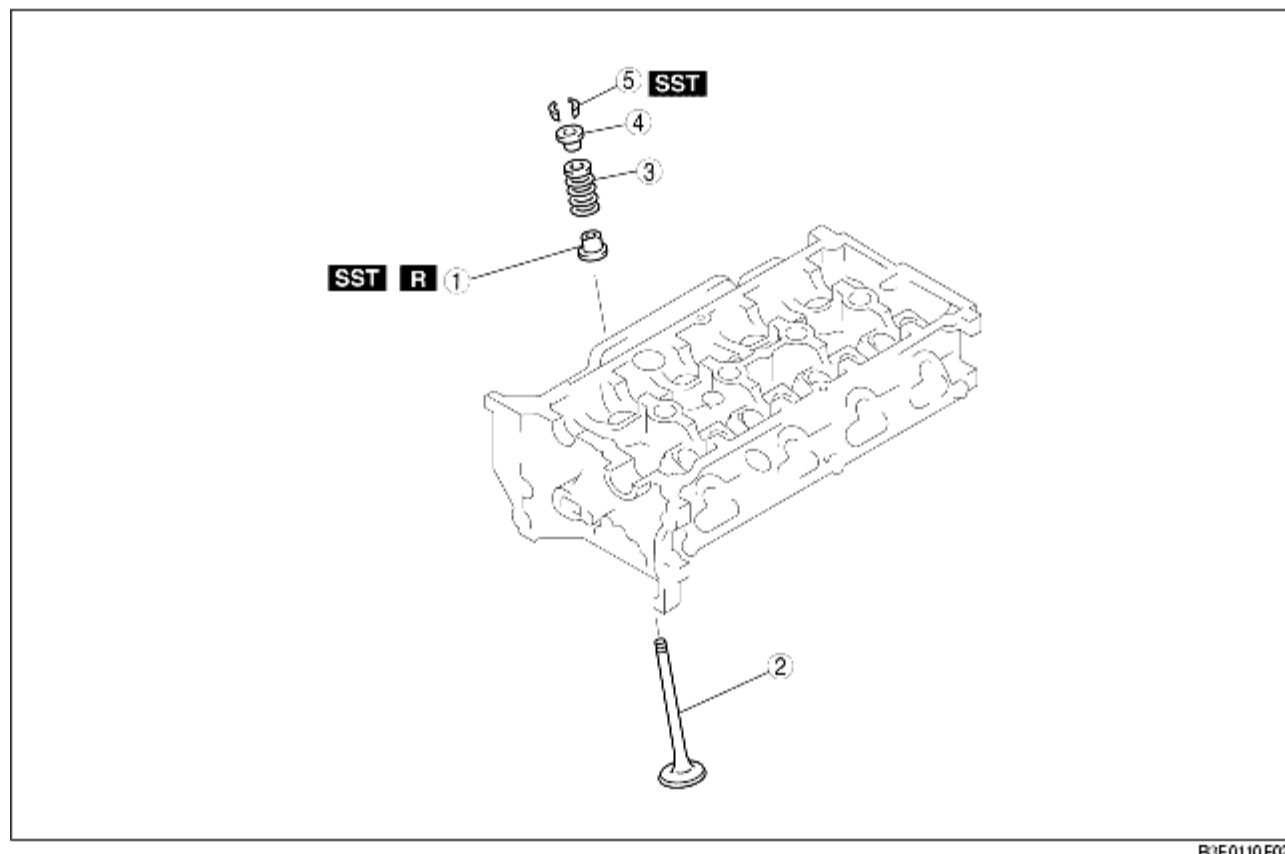

B3E0110 E029

1	Valve seal (See Valve Seal Assembly Note)
2	Valve
3	Valve spring
4	Upper valve spring seat
5	Valve keeper (See Valve Keeper Assembly Note)

Valve Seal Assembly Note

1. Press in the valve seal to the valve guide by hand.
2. Tap the **SST** shown in the figure using a plastic hammer.

Valve Keeper Assembly Note

1. Install the valve keeper using the **SST**.

